

**Light oil burners**  
**PRESS GV - GW - 1G - 2G - 3G - 4G**  
**one and two stage operation**

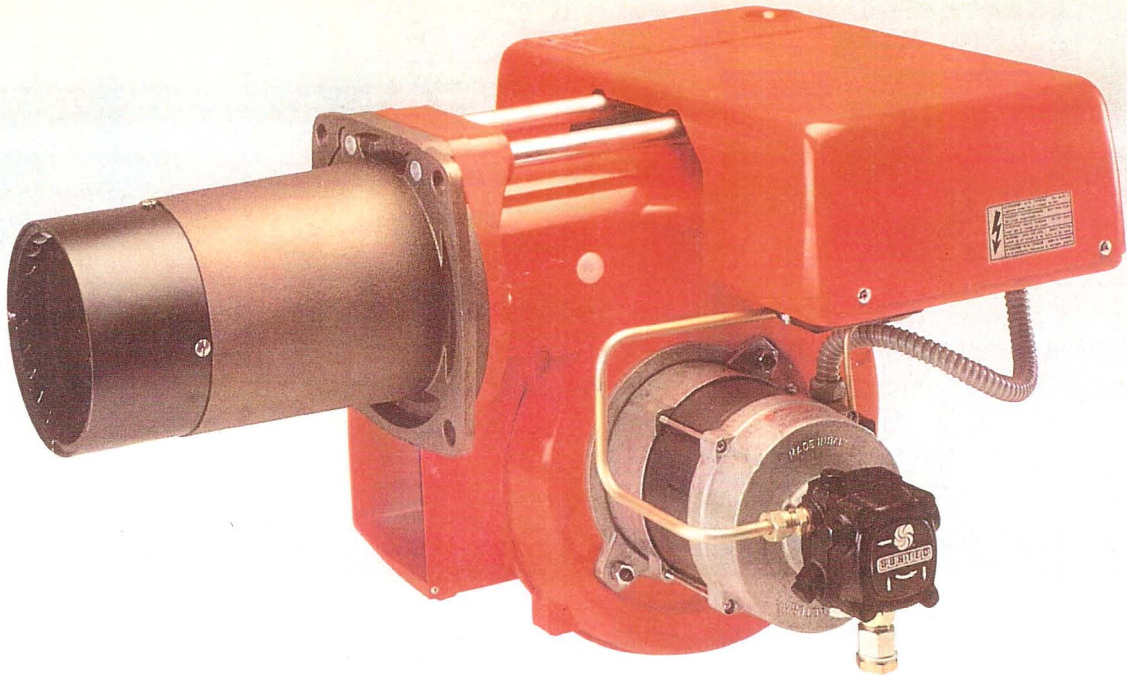

The Press G series of fully automatic monobloc oil burners comprises of six models with firing rates from 176 to 1660 KW.

Designed for use with light oil and specifically developed for application to heat generators with high combustion chamber resistances. All units, with the exception of the GV model which is a 1 stage burner, give 2 stage operation, through separate nozzles, thus protecting the boiler from thermal stresses and ensuring the automatic regulation of the firing rate between high and low flame levels depending upon the demands of the system.

The careful matching of the air handling parts to the combustion head ensures smooth starting and a high maintainable combustion efficiency. Fine tuning is by means of an external adjustment mechanism.

The safety devices and controls are grouped in a console at the rear of the burner, where a removable cover provides access as well as protection, while access to the combustion head for maintenance is effected by means of a «slide bar» system.

## Technical data and overall dimensions

MODEL	Delivery Kg/h		Power KW		DIMENSIONS mm										
	min.	max.	min.	max.	A	B	C	C1(*)	D	E	F	G	H	L	M
PRESS GV	15	30	178	356	439	234	185	320	473	397	292	140	160	M 10	155
PRESS GW	16	45	190	534	475	270	237	370	473	397	292	150	160	M 10	165
PRESS 2 G	30	60	356	712	475	270	245	403	506	437	332	155	160	M 10	165
PRESS 3 G	45	90	534	1186	611	406	254	412	570	485	370	175	195	M 12	185
PRESS 4 G	70	130	830	1660	670	316	200	426	720	590	445	205	230	M 12	210

Fuel light oil max. viscosity at 20°C 6 mm<sup>2</sup>/sec. (1,5°E)

Power supply : PRESS GV - GW : single-phase

PRESS 1G - 2G - 3G - 4G : threephase

\* Voltage and frequency have to be specified with the order.

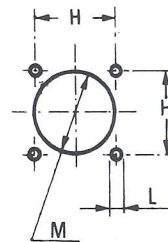
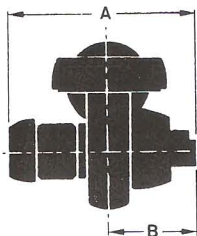
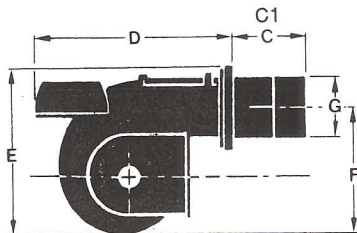

(\*) C1 - Combustion head extension obtainable with long blast tube, supplied on request.

**Firing rates: pressure in combustion chamber burner output**

(measured in combustion chamber during normal burner operation)

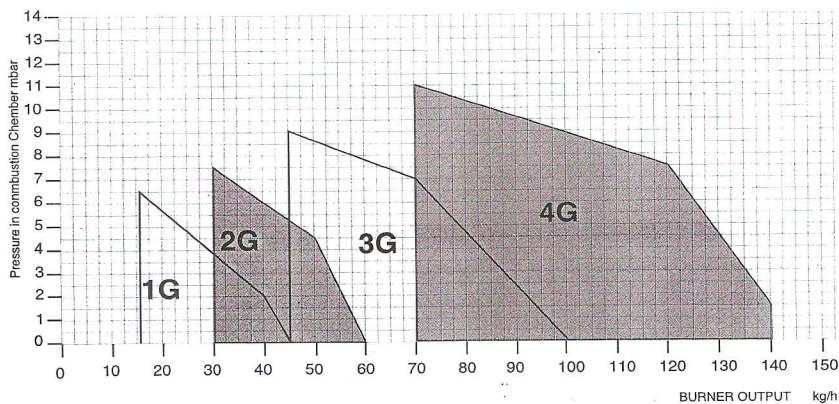
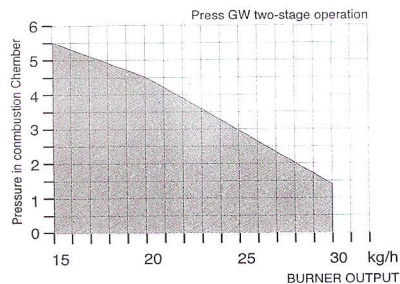
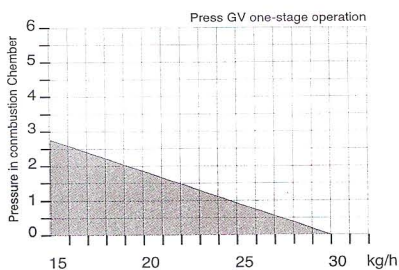

Manufactured by :

**RIELLO**  
**BURNERS**

**R.B.L. Riello Bruciatori Legnago S.p.A**

1 - 37045 LEGNAGO (VR.) ITALY

www.rielloburners.com

**SAMARTH**  
**ENGINEERS & CONSULTANTS**  
"Raghuvansh" Plot No. 481,  
Sai Section, AMBARNATH (E) - 421501.  
Tel. : 2603433 • Telefax : 2606377